

PUBLIC ART OPPORTUNITY

CALL FOR ARTISTS - Request for Proposals

Seamus Sims Skate Park Mural Project

The City of Port Townsend is seeking an artist or team of artists to create murals on vertical walls at the Seamus Sims Skate Park. The Skate Park is located at 250 Monroe Street in Port Townsend, WA.

CONTENTS:

- I. GENERAL INFORMATION/PROJECT DESCRIPTION**
- II. ARTIST REQUIREMENTS**
- III. BUDGET**
- IV. SUBMITTAL GUIDELINES**
- V. SELECTION**
- VI. SELECTION PANEL**
- VII. PRELIMINARY SCHEDULE**
- VIII. RUBRIC/ SELECTION CRITERIA**
- IX. DESIGN CRITERIA**
- X. COMMUNITY ENGAGEMENT CRITERIA**
- XI. CONTACT INFORMATION**
- XII. SITE INFORMATION AND PHOTOS**

I. GENERAL INFORMATION/PROJECT DESCRIPTION:

The goal of this project is to create permanent painted artwork at the Seamus Sims Skate Park that brings a vision of collaboration and creative expression to our streetscape. The project includes commissioning a mural by a Jefferson County based artist or artist team to be created in consultation with the park's constituents. Currently, the park is unpainted, grey concrete, offering a perfect canvas for artwork that reflects the vibrant culture that defines the activity and community who use this resource. Applicants will submit a community engagement plan as well as a design concept for approximately 1,700 square feet of painted murals at the park. The site includes long stretches of wall as well as smaller features to be integrated into the work. It does not include skateable surfaces or bowls in the Park. Please see the site information and photos section for more details.

The design should take into consideration ease of maintenance and resistance to vandalism. A primer coat and anti-graffiti coating will be provided by the City. Plans should include multiple ways to engage the community in the creative process. These activities will be supported by the City and Creative District in collaboration with the chosen artist(s).

II. ARTIST REQUIREMENTS:

- The artist may be an individual or a team that applies together with a lead artist.
- Artist is asked to submit evidence of work experience and past projects as they relate to this call specifically addressing evidence of:
 - Experience relevant to this type of project
 - Evidence of communication skills: verbal, written, and visual
 - Experience working with other design professionals and/or with communities
 - Availability/ability to begin work promptly and meet project schedules

Professional artists or teams may apply by submitting the requested materials to the City of Port Townsend, which is coordinating the project through the Arts Commission and Creative District. Highest consideration will be given to proposals from artists with connection to the Skate Park community and/or skate culture, although that will not be the only criterion used to judge applicants. Submittals must demonstrate an ability to successfully complete the project and fulfill the project criteria as described in this prospectus.

III. BUDGET:

Project Expenses	Description of Expense	Grant Amount	Match Amount	Total	Notes
Artist fees	Mural creation and community engagement by artist/s, and finalist stipends	\$26,000	\$5,500	\$31,500	Matched through private donations; includes \$1500 for finalists
Building permits/fees	City permit fees		\$750	\$750	City of PT Planning Department in-kind contribution
Site preparation and clear coating	Site prep, priming, and clear coating; in-kind labor		\$7,000	\$7,000	In-kind labor by City Parks Department
Paint		\$2,600	\$4,100	\$6,700	Arts Fund budget contribution
Site materials		\$1,400	\$2,200	\$3,600	Arts Fund budget contribution for primer and anti-graffiti clear coat
Total		\$30,000	\$19,550	\$49,550	

The City will provide site prep, priming, and anti-graffiti coating. Budget amounts includes applicable taxes. Artists should consider costs for community engagement activities in their budget. Taxes, insurance, and necessary licenses are the responsibility of the artist(s).

This project is being made possible by a Creative District grant from the Washington State Arts Commission (ArtsWA) as well as City funds and in-kind support, and private contributions.

IV. SUBMITTAL GUIDELINES:

Please include the following with your submittal:

- A one-page summary that includes a brief statement of your interest and concept for the project, collaborative skills, relevant experience--including community engagement and creative work--and technical ability.
- Current resume(s)/CV(s) of the artist/contractor(s) and any other team members.
- Reference list that includes the names, addresses, and phone numbers of three professional references who can speak to the quality of your artwork and experience in community-engaged projects.
- A combined work sample document of previous, related projects containing up to a total of 12 images. This document may be up to six pages in length. The identification for images must include the artist's name, title of work, brief project description, dimensions, date of completion, location of artwork, commissioning agency, budget, and collaborators with whom you worked (if appropriate).

Artist teams should appoint one team member as the lead artist whose qualifications and references will be used as the primary submittal for the team. They should submit a single summary with their team's concept and experience but provide individual resumes/CVs for each member. Work samples should include work for all members not exceeding 12 images in total for the team.

We encourage all kinds of artists and artist teams to apply, including artists whose team includes community members, youth, or other kinds of partnerships that support the best possible project for the community and the final visual product. Visual artists who need accommodations for the written or verbal portion of their submittal should contact us for alternative ways to apply.

Interested artists may submit their information to (FILLOUT FORM) Submittals may also be dropped off in person on a thumb drive at:

City of Port Townsend
ATTN: Katy Goodman
250 Madison Street
Port Townsend, WA 98368

Incomplete or late submissions will not be considered.

V. SELECTION:

The selection process follows guidelines laid out in the City's Art in Public Places Policies and Procedures, which includes convening an Artist Selection Panel made up of community members, City Advisory Board members, and the Public Art Committee.

The Artist Selection Panel will decide upon up to three artists or artist teams as finalists based on project concept, qualifications, the strength and quality of past work as demonstrated by their resume, and images of past projects. Finalists will be paid \$500 to prepare and present their engagement plan and design concept in a public meeting at the Cotton Building on Tuesday, June 23rd, 2026. The artists may be asked to follow up (in person or online) with the selection panel after this event to answer any further questions. The City of Port Townsend reserves the right not to award the project to any artists if they are not satisfied after these presentations.

All decisions and recommendations of the Artist Selection Panel are advisory and must be formally reviewed and accepted by the Port Townsend Art Commission and City Council prior to being considered final. If the selected artist(s) is approved by the City Council, the artist or team is expected to enter into a formal contract with the City of Port Townsend for the final process, design, and installation. The selected artist or team will be required to obtain a Washington state tax identification number, a City of Port Townsend Business License, and provide proof of insurance. Once completed, the artwork will become part of the City's Public Art Collection.

VI. ARTIST SELECTION PANEL

The Artist Selection Panel comprises members as prescribed by the City of Port Townsend's Art in Public Places Policies and Procedures. Serving on the committee are:

Leila Block, Artist
Evan Bombardier, Community Member
Katy Goodman, Arts and Culture Coordinator, Project Manager (non-voting)
Samantha Grace, Community Member
Dan Groussman, Public Art Committee, Arts Commission
Nicole Karn, Parks, Recreation, Trees and Trails Advisory Board
Zhenya Lavy, Historic Preservation Committee
Melanie Muszynski, Public Art Committee, Arts Commission
Christine Walsh Rogers, Public Art Committee, Arts Commission
Joshua Saunders, Public Art Committee, Arts Commission
Shawn Wiles, Parks Crew Chief Apprentice, Project Engineer (non-voting)

VII. PRELIMINARY SCHEDULE:

The following is the preliminary schedule for the project and is subject to change. Changes to the final installation deadline will be at the mutual agreement of the artist and the City of Port Townsend and may be subject to change. The ideal completion would be prior to November 1, 2026.

Call to Artists	April 1, 2026
Info Session	April 10, 2026, 3:30 p.m., City Council Chambers/Online
Submittal Deadline	May 25, 2026, 5:00 p.m.
Finalists Chosen	June 8, 2026
Finalist Presentations	June 23, 2026, 5:30 p.m., Cotton Building
Artist Selection by Committee	June 29, 2026
Selected Artist Recommended to Arts Commission	July 2, 2026
Selected Artist Recommended to City Council	July 6, 2026
Estimated Project Start	July 15, 2026
Estimated Project Completion	November, 1, 2026

VIII. RUBRIC

	Poor	Fair	Good	Very Good	Excellent	TOTAL
Letter of Interest /Application	1-4	5-8	9-12	13-16	17-20	20
CV/Experience	1-4	5-8	9-12	13-16	17-20	20
References	1-2	3-4	5-6	7-8	9-10	10
Work Samples	1-5	6-10	11-15	16-20	21-25	25
						75
Presentation and Public Engagement (Finalists)	1-5	6-10	11-15	16-20	21-25	25
						100

Letter of Interest/Application Criteria:

- Is Letter of Interest relevant, and does it describe a clear concept for the project? Does it include detailed information on all important points and evidence of a strong plan for community engagement?
- Does it demonstrate a connection to skate culture or the Skate Park community?
- Is application package complete and thorough?

CV/Experience Criteria

- Does CV/resume show significant evidence of prior work and proof of success?
- Does experience align with project goals and objectives?

References Criteria

- Do references support information in application and CV?
- Are references relevant to the project?

Work Sample Criteria

- Are work samples relevant to the project?
- Do samples show a high degree of artistic excellence?
- Do samples include all requested information as well as high-quality images?

Presentation/Public Engagement

- Does project concept as presented align with goals and objectives?
- Was presentation thorough and engaging?
- Was public reception positive (as measured by collected feedback)?
- Did artist answer any questions with relevant details?

IX. DESIGN CRITERIA

This City considers its property a limited public forum. Artwork cannot contain:

- Violent images
- Sexually graphic images
- Religious symbols or desecration of the same

- Hatred of persons or groups of people
- Support for or opposition to a candidate or initiative on the ballot
- Advertisement for a good or service for sale
- Imagery that may be inappropriate to maintain in or upon public property because it so objectionable under contemporary community standards that it is reasonably foreseeable to result in harm to, disruption of, or interference with the public's use of city property.

Design direction should align with the nature and culture of the Seamus Sims Skate Park as a vibrant, community-driven, multigenerational space for recreation, as well as reflecting Port Townsend's creative spirit and legacy of artistic expression.

The final design should take into consideration ease of maintenance and resistance to vandalism. A primer coat and anti-graffiti coating will be provided by the City.

X. COMMUNITY ENGAGEMENT CRITERIA

Artist(s) community engagement plan should include multiple opportunities for input and project development with Skate Park users and other stakeholders. It should take into account timing for planning, promotion, activities, and feedback as well as the execution of the mural. Engagement activities will be supported by the City and Creative District in collaboration with the chosen artist(s).

XI. CONTACT INFORMATION

For any questions regarding the project or to schedule a site visit, please contact Katy Goodman, arts and culture coordinator, at (360) 774-2362 or kgoodman@cityofpt.us. You may also come by the Artist Resource Help Desk at the Port Townsend Public Library on Thursdays between 12:00-2:00. An Informational Session about the project will be held on Friday, April 10th, at 3:30 p.m. in City Council Chambers and can be attended online. It will be recorded and made available for viewing afterwards as well. Details at: ptcreativedistrict.org/skatepark/

XII. SITE INFORMATION AND PHOTOS

(See Attachments)

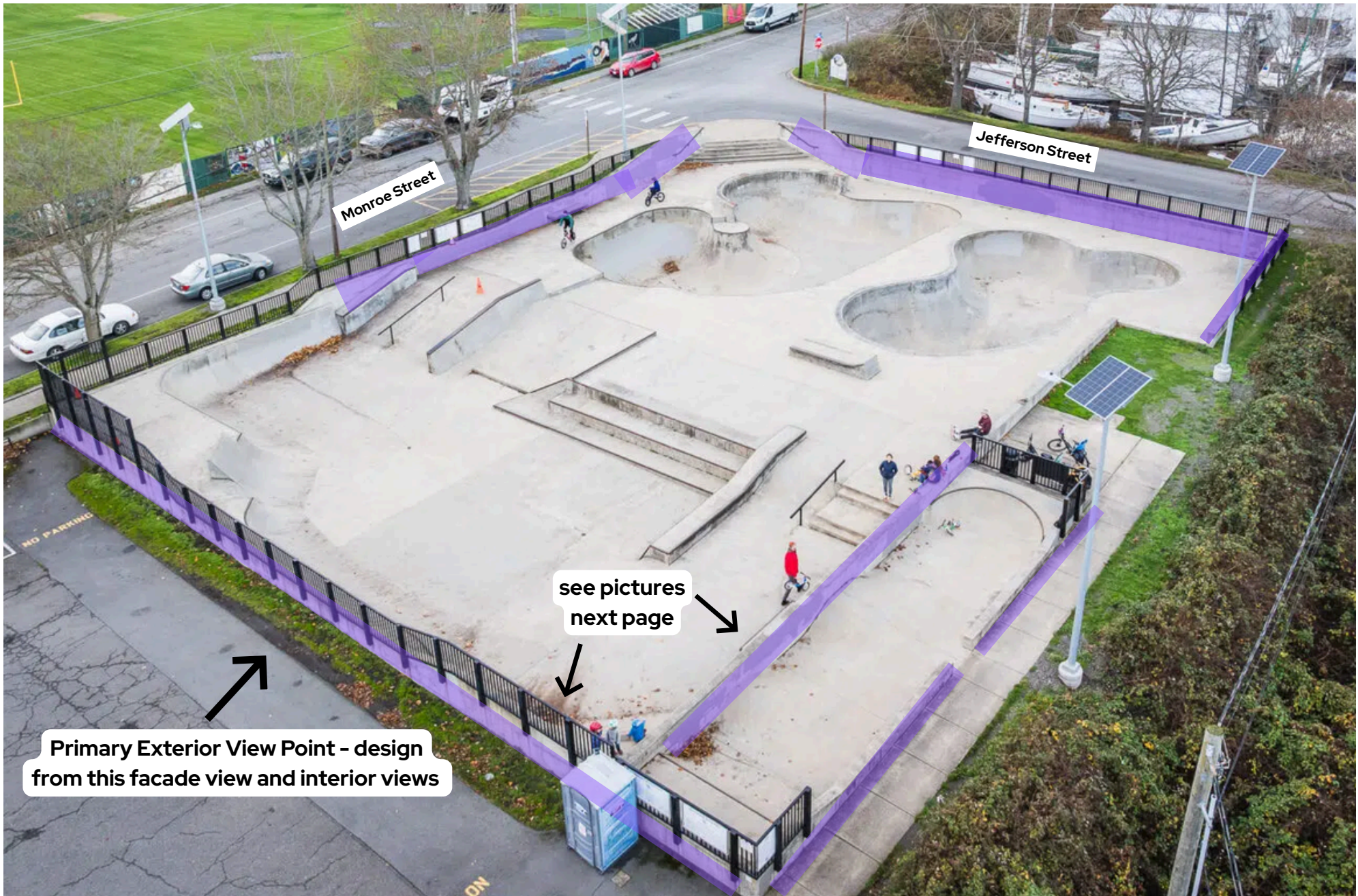

Monroe Street

Jefferson Street

see pictures
next page

Primary Exterior View Point - design
from this facade view and interior views



Interior wall elevations - inside south parking lot wall and inside beginners area wall

PROJECT SITE

VICINITY MAP

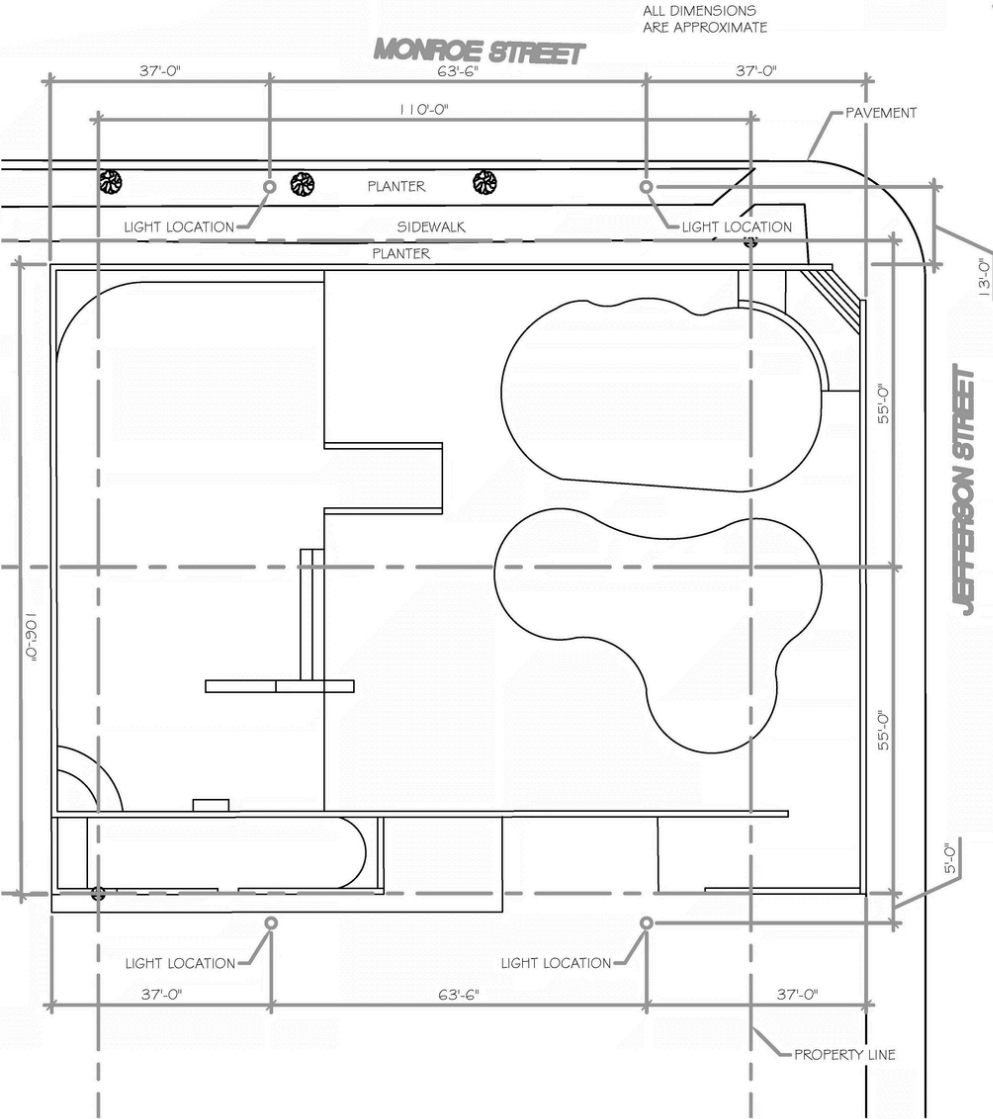
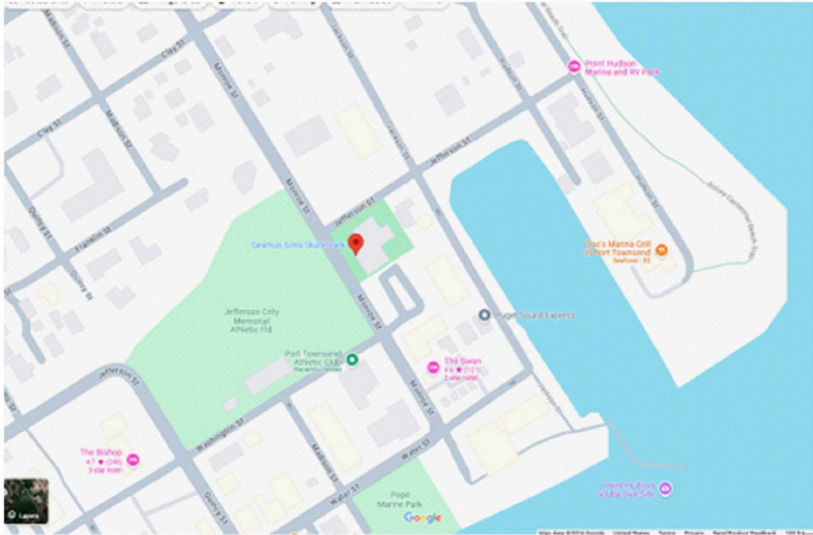

ALL DIMENSIONS ARE APPROXIMATE

REVISION	
NO.	DATE / DESCRIPTION

© 2021 SEAMUS SIMS SKATE PARK
 ALL RIGHTS RESERVED
 THIS DOCUMENT IS THE PROPERTY OF SEAMUS SIMS SKATE PARK AND IS NOT TO BE REPRODUCED OR TRANSMITTED IN ANY FORM OR BY ANY MEANS, ELECTRONIC OR MECHANICAL, INCLUDING PHOTOCOPYING, RECORDING, OR BY ANY INFORMATION STORAGE AND RETRIEVAL SYSTEM, WITHOUT THE WRITTEN PERMISSION OF SEAMUS SIMS SKATE PARK.

DESIGNED BY:
RESIR ENGINEERING, PLLC
 4472 LOPEZ AVENUE
 PORT TOWNSEND, WA 98365
 (360) 331-1128

PROJECT NO.:
SEAMUS SIMS SKATE PARK

CITY OF PORT TOWNSEND
 1000 MARINE STREET
 PORT TOWNSEND, WA 98365
 TEL: (360) 705-0200

SITE PLAN & GENERAL NOTES

DATE: 10/28/24
 SHEET NO.: 0415
 SHEET NUMBER:
50